

PCB Layout(Pattern side)

Circuit Diagram

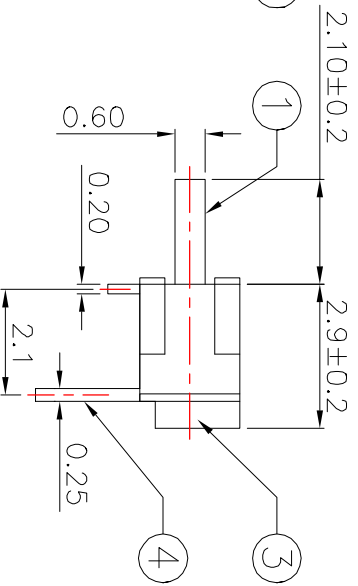
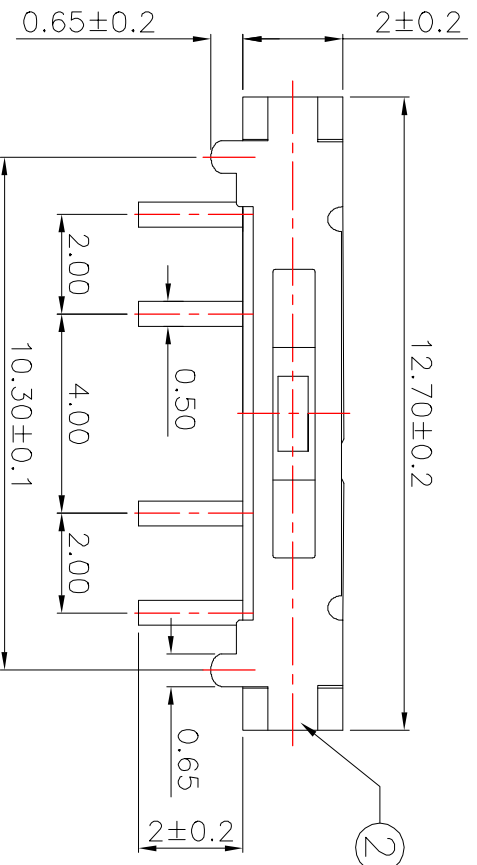

Note:
Operating force: 200±50gf

⑤	Contact Spring	—	1	Beryllium copper	Ag Plated	—
④	Terminal	—	4	Brass Strip	Ag Plated	—
③	Base	—	1	LCP	Black	—
②	Cover	—	1	SUS	Natural	—
①	Knob	—	1	NYLON	White	—
ITEM	PART NAME	TER'NO.	QTY.	MATERIAL	FINISHING	REMARK

APPROVALS		DATE
DRAWN		2019.10.12
CHECKED		
APPROVALS		
TITLE:		TOGGLE SWITCHES
PART NO.		K3-1370D-G2
SCALE:		1:1
DRAWING NO.		
SHEET		1 OF 1

ECN NO.	REV.	DATE.	DESCRIPTION.	CHANGE.	CHECK.	APPRO.
	A		NEW			
TOLERANCES ARE						
		30~12.5	±0.30		ANGLE	
		10~30	±0.20			
		5~10	±0.15		±2'	
		~5	±0.10			

LCZY ELECTRONICS(SHEN ZHEN)CO.,LTD