

RECOMMENDED P.C.B. LAYOUT
UNSPECIFIED TOLERANCE:±0.05
(TDP VIEW)

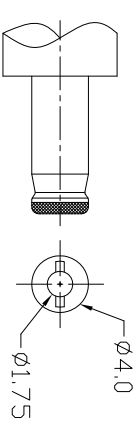
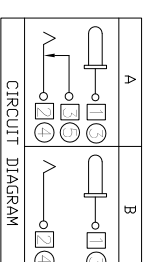

```

MODEL CODE:
DCB0-00430- A G PB BK S 0 4
(1) (2) (3)(4)(5) (6) (7)(8) (9)
(1):Series type:DIP DC POWER JACK
(2):Series No.
(3):Schematic option: A , B
(4):Center pin diameter:
G=Ø1.65
(5):Material of housing:
PB=PB (Standard)
(6):Housing color:
BK=Black (Standard)
(7):Terminal plating
S=Silver(Ag)
(8):Special option:
0=No special option
(9):Packing mode:
4=Bag packing

```

SPECIFICATION:

- 1.Rating : DC 30V 1A;
- 2.Contact resistance: $\leq 30m\Omega$;
After test: $\leq 50m\Omega$
- 3.Insulation resistance: $\geq 100M\Omega$ (DC500V);
After test: $\geq 50M\Omega$
- 4.Withstand voltage: 500VAC ;
- 5.Insertion and extraction force: 3-30N;
- 6.life test: 5,000 cycles;
- 7.Operation temperature range:-20°C~70°C;
- 8.Preservative temperature range:-40°C~85°C;

LONGCHUANG ZHONGYE (HK)CO.,LIMITED									
TITLE:		PART NO.:		DCB0-00430					
DIP DC POWER JACK									
DR: Jieky 2019/04/12		DWG NO.:		AB0-00430					
CHKD: Jieky 2019/04/12									
APPD:		SCALE		SHEET		REV.		CUSTOMER DRAWING	
		1:1		1/1		A			
UNITS		mm							
TOLERANCE		ANGLES							
.X ±0.50		X ±5°							
.XX ±0.30		.X ±3°							
.XXX ±0.15		.XX ±2°							
FINISH		SEE NDTE							
Q'TY		SEE NDTE							
APPD:		SCALE		SHEET		REV.		CUSTOMER DRAWING	
		1:1		1/1		A			
UNITS		mm							
TOLERANCE		ANGLES							
.X ±0.50		X ±5°							
.XX ±0.30		.X ±3°							
.XXX ±0.15		.XX ±2°							
FINISH		SEE NDTE							
Q'TY		SEE NDTE							
APPD:		SCALE		SHEET		REV.		CUSTOMER DRAWING	
		1:1		1/1		A			